

PURE FLOW

Instruction manual



PURE FLOW Instruction manual

Healthy water – healthy life Thank you for choosing PURE FLOW!

PURE FLOW is an advanced 8-stage water filtration system, designed to provide you with clean, pure, alkaline and ionized water.

At Friway, we care not only for the body – but also for the planet.
That is why we have chosen not to include a printed manual in the box.

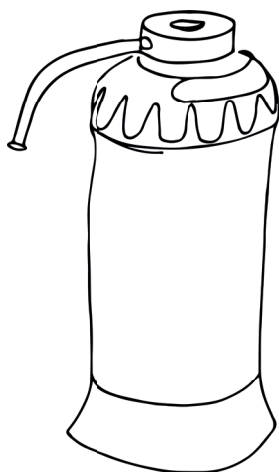

Please read this instruction manual carefully before installing and using the device.

Index:

1. Technical Data	Page 3
2. Assembly Instructions	Page 4
3. User Guide	Page 6
4. How to change the filter/clean the ceramic filter	Page 7
5. Points to note	Page 8
6. Frequently asked questions	Page 9

1. TECHNICAL DATA

Effluent water flow:	1.0 L/min
Work pressure:	0.1–0.4 MPa
Water inflow pH value:	6.8–7.2
Water inflow temperature:	2°C–40°C
Dimension of device:	13 mm × 360 mm
Net weight of device:	3.5 kg
Waterproof grade:	PX1

PURE FLOW Instruction manual

2. ASSEMBLY INSTRUCTIONS

A. Overview

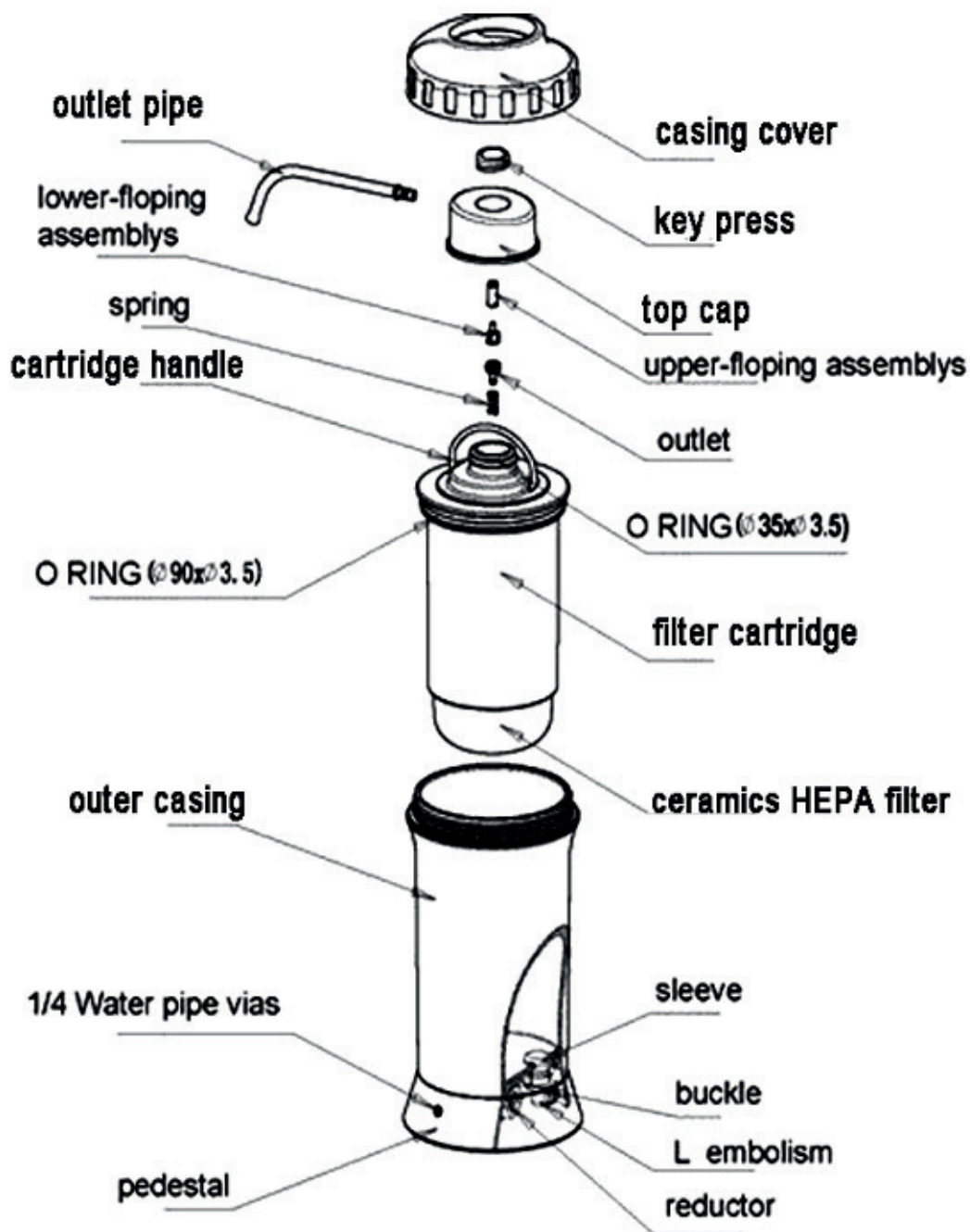

PURE FLOW Instruction manual

B. Diagram – Underneath the base of the device

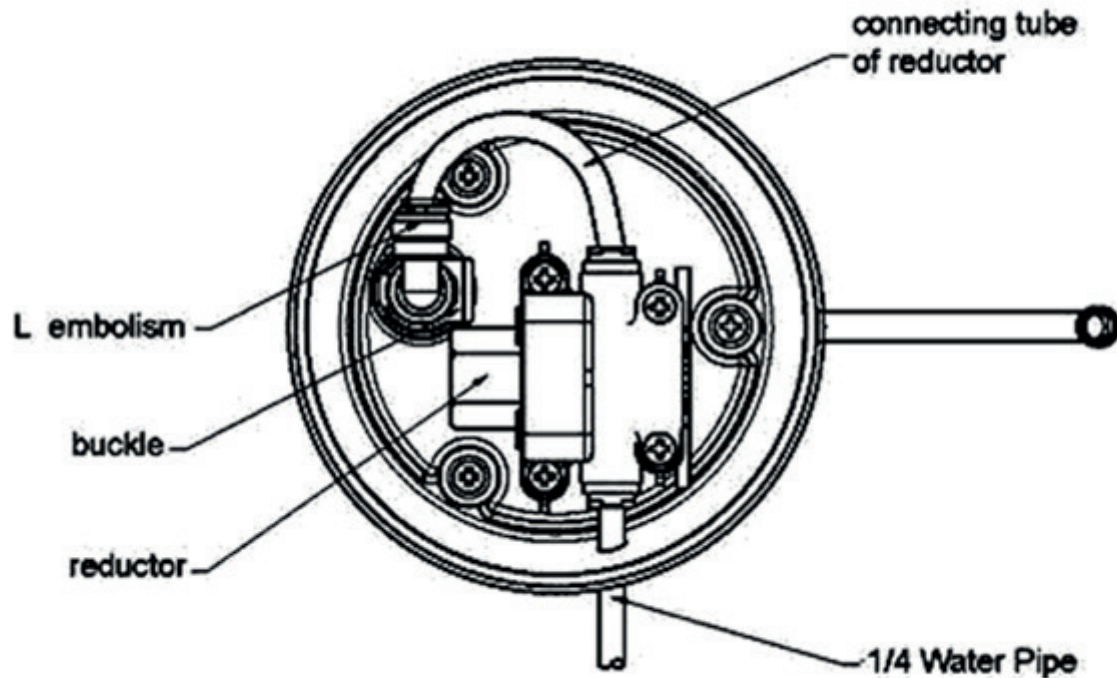

C. Accessories included

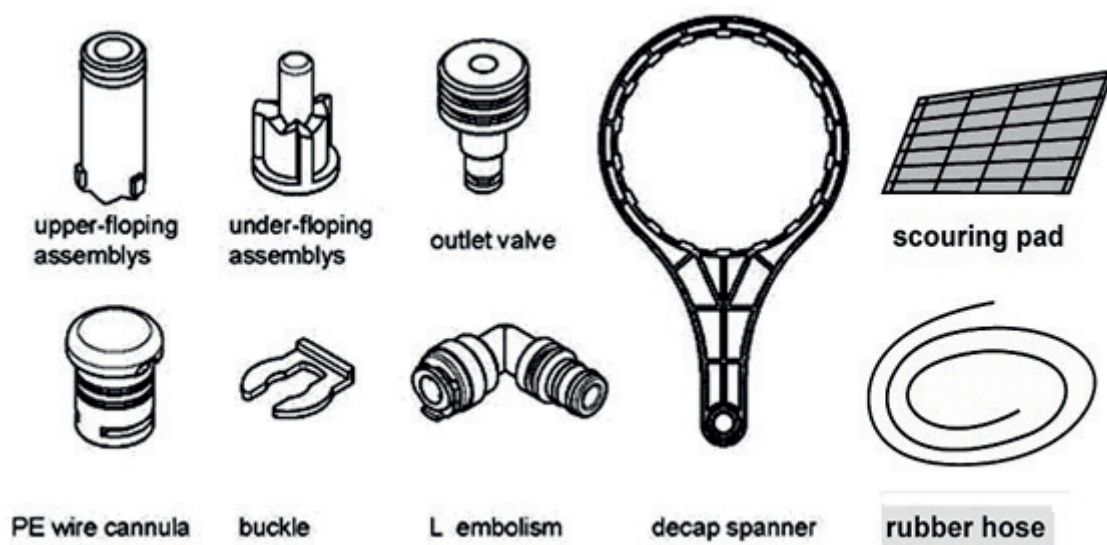

D. Assembly:

1) Attaching the Diverter Vale to your tap

(Please note, check the small installation guide for step-by-step instructions with photos).

2) Attaching the unit to the tap

1. Insert outlet pipe into top cap.
2. Screw the diverter valve on to the tap head.
3. connect one end of the rubber hose to the diverter valve and screw it on tightly.
4. Insert the hose through the hole in the base stand.

3. USER GUIDE

1. After installation, turn on the tap and let water run through the system for at least 30 minutes. The filtered water will be murky or slightly greyish/blackish due to carbon dust being washed off from carbon filters. Once water runs clear, the filtered water can be used straight away for drinking, washing or cooking.
2. When you turn off the tap, filtered water may still flow out for another 20-30 seconds. This is due to the residual pressure that has built up within the system while it was in use.
3. If the system is left unused for a few days, the initial flow of the filtered water will be slightly greyish as it would have been soaking in the filter for a prolonged period. Just run the water for about 1-3 minutes until

PURE FLOW Instruction manual

it runs clear and the system is ready for regular use again.

4. HOW TO CHANGE THE FILTER/ CLEAN THE CERAMIC FILTER

1) Removing the ceramic filter for periodic cleaning:

When the filtered water from your tap runs slow or it stops running completely, this indicates that the ceramic filter in the cartridge is covered with sediment or impurities, clogging up the system. This filter then needs to be cleaned.

Please note, use the scouring pad provided. Do NOT use a hard toothbrush

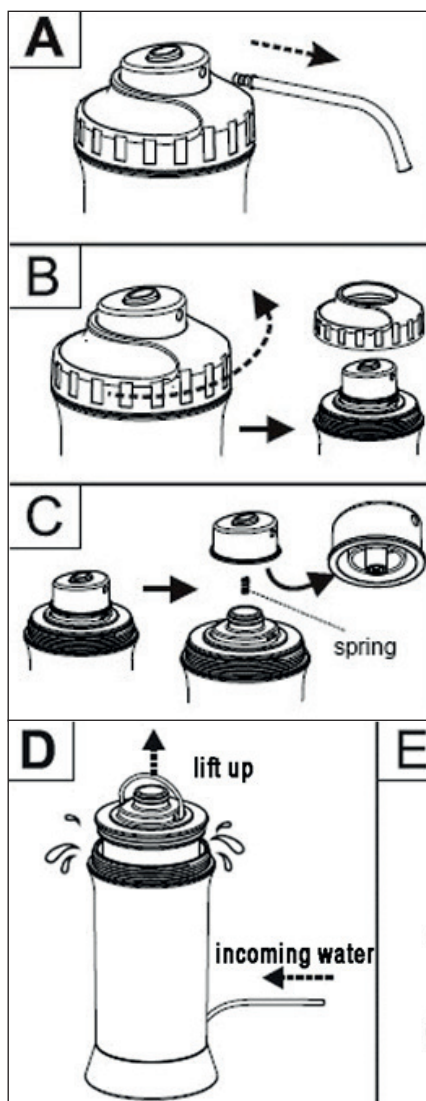

1. Turn off the system
2. Pull out the outlet pipe from the top cap (Diagram A)
3. Turn casing cover anti-clockwise to loosen (Diagram B)
4. Pull off the top cap (Diagram C)
5. Important: Turn on tap water and it will push the filter cartridge up (Diagram D)
6. Take the filter out and wash with the scouring pad provided (Diagram E)
7. Fill with water up to around 1/5 of the base, then turn off the tap
8. Carefully re-install the filter cartridge
9. Finally re-attach the top-cap. Then screw on the casing cover clockwise and reconnect the outlet pipe.

2) Replacing the filter cartridge

The filter cartridge will need to be replaced after about 5,000 litres of water or 6 months of usage. However, this depends on incoming water quality and volume of use. When the ceramic filter breaks due to wear and tear or if filtered water tastes of chlorine, it is time to replace the filter cartridge. To replace the cartridge, please refer to the same procedure as taking out the cartridge for periodic cleaning.

5. POINTS TO NOTE

1. Turn off the tap when you go out.
2. Keep the water filter unit near the tap. Don't place the device close to a heat source or a power socket and don't put it in the fridge or freezer, as this could damage the device.
3. Ensure that the plastic pipe of the device is not too close to a cooker or other heat source.
4. Do not run hot water through the water filter. This will damage the device.
5. The device must be installed in accordance with the instruction manual. Please keep small children under 7 away from the unit during the installation process.
6. If the water flow from the device is slower than normal, please wash the ceramic filter.
7. On first use or if the filter cartridge has been replaced, let the water run for at least 30 minutes before usage.
8. Always turn the tap off after use and switch the diverter valve to the unfiltered tap water setting when the filter is not in use. Otherwise, the water pressure will build up in the unit and water will rush out when you open the tap.
9. After assembling the unit, turn on the tap and let the water run for 30 minutes through the filter and it will be ready for use.
10. Never use any cleaning liquid, detergent or alcohol to clean the filter or any part of the device.
11. If installation and usage is not carried out in accordance with the user manual and the device is subsequently damaged or financial loss is incurred, this is the responsibility of the consumer. Kindly read the instructions carefully and enjoy a healthy life using your PURE FLOW!

6. FREQUENTLY ASKED QUESTIONS

Q1: Is it safe to drink water directly from PURE FLOW water purifier without boiling the water first?

A: YES! The PUREFLOW water purifier provides not only clean, but also safe and health-giving water on demand. Boiling water before consumption has long been practised to offer consumers assurance that the water is free from bacteria, but in actual fact, municipally treated water has been chlorinated to kill bacteria present in our tap water, so boiling water is not necessary. Instead, a good filtration and purification system removes hazardous contaminants from the tap water such as chlorine, heavy metals, rust, lead and many other substances. However, you can of course boil the filtered water for cooking and hot drinks.

Q2: Can I use the PURE FLOW water purifier for untreated underground water?

A: Untreated underground water consists of an extremely wide spectrum of contaminants. This makes it even more important to use the PURE FLOW water purifier, since the device will improve the quality of the untreated underground water. For this type of water, just boil the filtered water before drinking.

Don't be alarmed if you notice any whitish specks in the filtered water after boiling. These are specks of calcium, which are not harmful in any way. The filtered water is clear of impurities and will not transform magnesium and calcium ions into limescale. The filtered water only retains those mineral ions which are good for the human body. When the filtered water is left to cool after boiling, there may be fine specks floating on the water surface and some at the bottom of your water container. This is not a cause for concern, since these minerals are healthy and safe to consume. If the water supply comes from an area with limestone-based soil or the surrounding areas are calcium rich, then the water would contain very high calcium levels.

Q3: If the filtered water has a peculiar smell and tastes different, what should I do?

A: The change of smell and taste could happen if there is water contained inside the unit for a few weeks. In this case, it is best to remove the cartridge and drain the surplus water. All you need to do is rinse the casing and unit for at least 15 minutes before resuming usage.

Q4: Can I run hot water through the PURE FLOW water purifier?

A: No! Hot water will affect the efficacy and efficiency of both the ceramic filter and the carbon filter inside the unit, compromising the quality of the filtered water.

Q5: Will boiling PURE FLOW water affect its health-giving properties?

A: No! When the filtered water is heated, the molecular clusters will temporarily break up. Once cooled, the water molecules will regroup to their original stable cluster arrangement with all healthful properties intact.

Q6: Is PURE FLOW water suitable for infants?

A: Certainly! Our human body fluids are naturally made up of small molecular clusters. Giving infants and children PURE FLOW filtered water with its small molecular clusters and health-giving properties is very important to ensure maximum hydration for optimum growth and development.

PURE FLOW water is perfectly safe and is the best kind of water you can give your children.

Q7: Can sick people benefit from PURE FLOW water?

A: Yes. In fact, cellular dehydration is one of the root causes of many illnesses and diseases. Health experts and doctors always advocate drinking plenty of water whenever a patient is sick, in pain or on medication. Water hydrates the cells and flushes out toxins. PURE FLOW water reaches the cells better and faster than most other types of water and should help expedite recovery and establish overall wellness. Those with illnesses should increase their consumption of PURE FLOW water to at least 10-15 glasses per day during convalescence.

Q8: Is PURE FLOW alkaline pH water suitable for cleansing the face?

A: Absolutely. The filtered water will not disturb the skin's normal pH balance (the so called 'acid mantle'). Unlike tap water, PURE FLOW water is completely free from skin ageing contaminants and chlorine. Its bio available ionic minerals and oxygen accelerate the natural regenerative process to give you a healthier, clearer complexion.